

Ridgefield Boro - Discharge Points

Legend

- Util_SW_Outfalls
- Roads
- Waterways
- MUN**
- RIDGEFIELD BORO

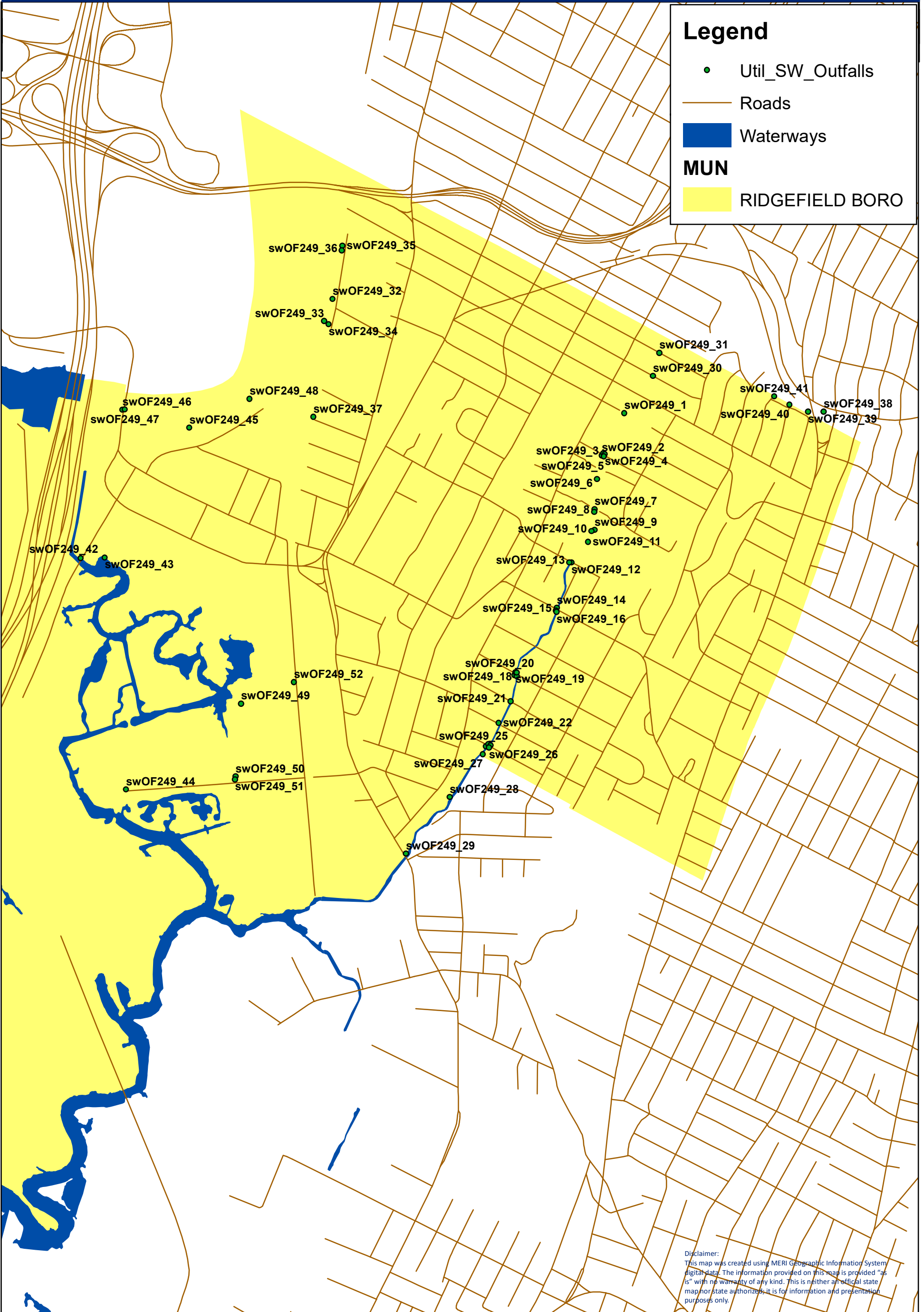

Disclaimer:
This map was created using MERI Geographic Information System digital data. The information provided on this map is provided "as is" with no warranty of any kind. This is neither an official state map nor state authorized; it is for information and presentation purposes only.

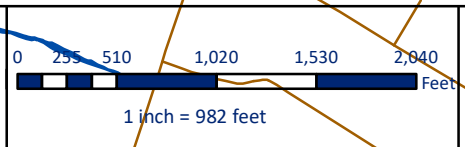

Units: US Survey Feet
Datum: North American Datum 1983
Coordinate System: NJ State Plane
Data Source(s): MERI, NJDEP, NJDOT

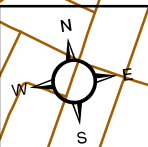

Ridgefield Utilities

OBJECTID	FacilityID	Municipality	Municipal Code	Receiving	Date Created	Date Modified	POINT_X	POINT_Y
1	swOF249_1	Ridgefield	249		12/14/2012	12/14/2012	631063.13	729959.82
2	swOF249_2	Ridgefield	249		12/14/2012	12/14/2012	630759.46	729544.97
3	swOF249_3	Ridgefield	249		12/14/2012	12/14/2012	630777.33	729566.00
4	swOF249_4	Ridgefield	249		12/14/2012	12/14/2012	630794.50	729551.28
5	swOF249_5	Ridgefield	249		12/14/2012	12/14/2012	630781.53	729532.01
6	swOF249_6	Ridgefield	249		12/14/2012	12/14/2012	630672.11	729298.57
7	swOF249_7	Ridgefield	249		12/14/2012	12/14/2012	630600.36	728981.45
8	swOF249_8	Ridgefield	249		12/14/2012	12/14/2012	630592.26	728952.17
9	swOF249_9	Ridgefield	249		12/14/2012	12/14/2012	630570.45	728761.52
10	swOF249_10	Ridgefield	249		12/14/2012	12/14/2012	630533.90	728752.80
11	swOF249_11	Ridgefield	249		12/14/2012	12/14/2012	630485.20	728644.49
12	swOF249_12	Ridgefield	249		12/14/2012	12/14/2012	630274.20	728448.45
13	swOF249_13	Ridgefield	249		12/14/2012	12/14/2012	630252.60	728451.77
14	swOF249_14	Ridgefield	249		12/14/2012	12/14/2012	630051.30	727987.54
15	swOF249_15	Ridgefield	249		12/14/2012	12/14/2012	630037.89	727960.72
16	swOF249_16	Ridgefield	249		12/14/2012	12/14/2012	630041.73	727946.04
17	swOF249_17	Ridgefield	249		12/14/2012	12/14/2012	629500.92	727334.99
18	swOF249_18	Ridgefield	249		12/14/2012	12/14/2012	629520.71	727322.22
19	swOF249_19	Ridgefield	249		12/14/2012	12/14/2012	629515.60	727363.72
20	swOF249_20	Ridgefield	249		12/14/2012	12/14/2012	629526.46	727358.62
21	swOF249_21	Ridgefield	249		12/14/2012	12/14/2012	629419.83	727063.15
22	swOF249_22	Ridgefield	249		12/14/2012	12/14/2012	629258.92	726848.51
23	swOF249_23	Ridgefield	249		12/14/2012	12/14/2012	629089.64	726618.41
24	swOF249_24	Ridgefield	249		12/14/2012	12/14/2012	629117.63	726638.50
25	swOF249_25	Ridgefield	249		12/14/2012	12/14/2012	629137.72	726624.15
26	swOF249_26	Ridgefield	249		12/14/2012	12/14/2012	629119.78	726601.91
27	swOF249_27	Ridgefield	249		12/14/2012	12/14/2012	629045.15	726540.19
28	swOF249_28	Ridgefield	249		12/14/2012	12/14/2012	628626.53	726133.58
29	swOF249_29	Ridgefield	249		12/14/2012	12/14/2012	628075.73	725594.53
30	swOF249_30	Ridgefield	249		12/14/2012	12/14/2012	631422.15	730314.15
31	swOF249_31	Ridgefield	249		12/14/2012	12/14/2012	631525.99	730550.07
32	swOF249_32	Ridgefield	249	OVERPECK CREEK	12/14/2012	3/15/2016	628124.31	731613.55
33	swOF249_33	Ridgefield	249	OVERPECK CREEK	12/14/2012	3/15/2016	628000.86	731392.23
34	swOF249_34	Ridgefield	249	OVERPECK CREEK	12/14/2012	3/15/2016	628046.46	731348.85
35	swOF249_35	Ridgefield	249	OVERPECK CREEK	12/14/2012	3/15/2016	628306.71	732165.18
36	swOF249_36	Ridgefield	249	OVERPECK CREEK	12/14/2012	3/15/2016	628296.57	732117.23
37	swOF249_37	Ridgefield	249	OVERPECK CREEK	12/14/2012	3/15/2016	627744.32	730389.27
38	swOF249_38	Ridgefield	249		12/14/2012	12/14/2012	633188.22	729677.74
39	swOF249_39	Ridgefield	249		12/14/2012	12/14/2012	633021.49	729703.06
40	swOF249_40	Ridgefield	249		12/14/2012	12/14/2012	632836.48	729805.77
41	swOF249_41	Ridgefield	249		12/14/2012	12/14/2012	632684.53	729913.40
42	swOF249_42	Ridgefield	249	BELLEMANS CREEK	12/14/2012	12/14/2012	625053.09	729229.37
43	swOF249_43	Ridgefield	249	BELLEMANS CREEK	12/14/2012	12/14/2012	625310.44	729201.09
44	swOF249_44	Ridgefield	249	BELLEMANS CREEK	12/14/2012	12/14/2012	625190.69	726699.09
45	swOF249_45	Ridgefield	249	OVERPECK CREEK	12/14/2012	12/14/2012	626406.48	730457.76
46	swOF249_46	Ridgefield	249	OVERPECK CREEK	12/14/2012	12/14/2012	625718.19	730748.12
47	swOF249_47	Ridgefield	249	OVERPECK CREEK	12/14/2012	12/14/2012	625746.14	730747.38
48	swOF249_48	Ridgefield	249	OVERPECK CREEK	12/14/2012	12/14/2012	627092.45	730675.08
49	swOF249_49	Ridgefield	249	BELLMANS CREEK	6/30/2014	3/15/2016	626543.28	727440.80
50	swOF249_50	Ridgefield	249	BELLMANS CREEK	6/30/2014	3/15/2016	626375.34	726673.35
51	swOF249_51	Ridgefield	249	BELLMANS CREEK	6/30/2014	3/15/2016	626365.77	726643.06
52	swOF249_52	Ridgefield	249	BELLMANS CREEK	6/30/2014	3/15/2016	627138.98	727592.04